

Side 1

Reference Guide

Enbrel® (en-brel) (etanercept)
Injection for subcutaneous use
Single-dose Prefilled SureClick® Autoinjector

TS00908

Read all instructions in carton before use.

Questions? 1-888-4ENBREL (1-888-436-2735)
or visit www.injectingenbrel.com

Guide to parts

Purple start
button
Expiration
date

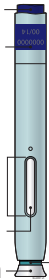

Window
Medicine

Green
safety
guard
(needle
inside)

White cap on

Wait at least 30 minutes
for the autoinjector to
come to room temperature
before giving your injection.

Prepare and clean
your injection site.

1

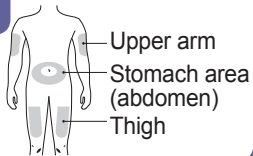

Upper arm

Stomach area
(abdomen)

Thigh

Pull the white cap straight off only when you
are ready to inject. **Do not** leave the white cap off for
more than 5 minutes. This can dry out the medicine.

2

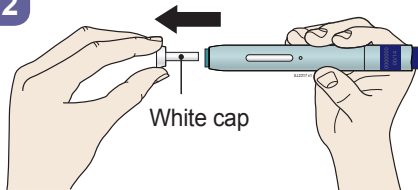

Turn over to continue

Side 2

Reference Guide

Enbrel® (en-brel) (etanercept)
Injection for subcutaneous use
Single-dose Prefilled SureClick® Autoinjector

AMGEN®

© 1998-2016, 2019
Immunex Corporation
All rights reserved.
Revised: 10/2019 v7

Read other side first

USA-916-81514

Stretch or pinch your injection site to create a firm surface.

3

Stretch method:



or

Pinch method:



Put the green safety guard (needle inside) on your skin at 90 degrees.

4

Green safety guard (needle inside)

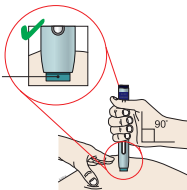

Firmly push down the autoinjector onto your skin until it stops moving.

5

When you are ready to inject, **press** the purple start button. You will hear a click.

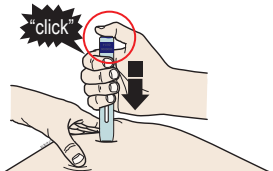

Keep pushing down on skin for **about 15 seconds**.

6



Window turns from clear to yellow when the injection is done.

